

AP1-IR Series

Outdoor Night Vision Type Intelligence PTZ Camera



MAIN FEATURES

Weatherproof design with aluminium die-cast casing
Catch night image promptly with high output infrared LED, up to 150 meters illuminating range
Continuous rotation + 180 degree angle without blind spot
OSD menu function
Auto start tracking function
Super shockproof
Built-in surge/lightning protector
IP66 protection



AP1-IR

AP1-IR series Outdoor Night Vision Type Intelligence PTZ Camera is a heavy-duty all-in-one high-tech monitoring product, which integrates high-definition color video camera, universal gear change pan & tilt, multi-function telemetry receiver, high output infrared LED and alarm function. This PTZ camera is very easy to install and maintain with many features like perfect shape, responsive and simple operation.

It is a high compatibility product consists of built-in telemetry receiver with multi-protocol, configure by using simple finger-switch inside the device. The horizontal rotation is continuous and during low speed circulating, it is very stable and low noise. The viewing angle is all direction without blind spot. When the system identifies the alarm signal, the pan & tilt and camera will response immediately to report the picture of alarm district to main monitor.

AP1-IR can be integrated with most type of zoom camera module, for easier selection and application to suit various operating environment. It is designed for rough outdoor environment operation, with built-in sunshield to reduce the temperature caused by direct sunlight. The built-in wiper mechanism may reduce the effect of dusts, rain drops and condensates on the camera sight glass, for improved video quality.

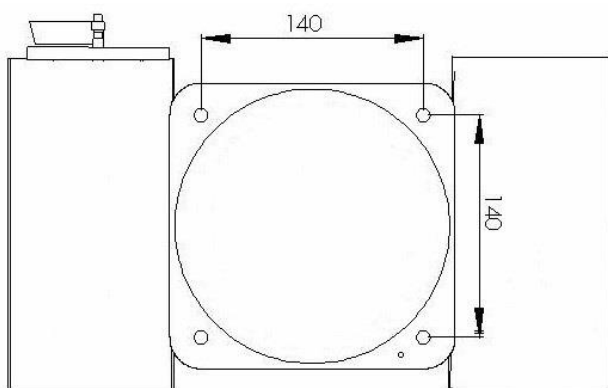

Base Mounting Dimensions

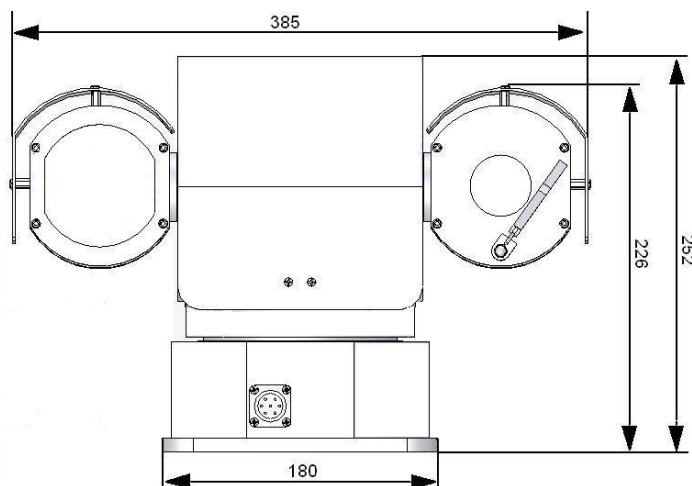

Outline Dimensions

AP1-IR Series

Outdoor Night Vision Type Intelligence PTZ Camera



TECHNICAL DATA

GENERAL

Ingress Protection IP66

Operating Temperature -35°C to 55°C

Relative Humidity 90%

MECHANICAL

Die-cast aluminum material

Built-in wiper mechanism at sight glass

Overall dimension (WxHxD): 385×226×200mm

6kg weight (without camera module)

Pan Speed 0.1° ~ 100°/s

Tilt Speed 0.1° ~ 60°/s

Pan range 360° Continuously

Tilt range -90° ~ +90°

ELECTRICAL

Operating Voltage : AC24V 50/60Hz

Power consumption 60VA

Built-in surge/lightning protector

INFRARED ILLUMINATOR

IR illuminating range 150m (max)

TELEMETRY RECEIVER

RS485 or RS422 connection

Pelco D and Pelco P. Other protocols based on request.

4 programmable tracks, 2 scanning tracks, 12 private zones

Auto start tracking function

OSD menu function

4-alarm input, 2-alarm output (selection)

128 preset (max)

STANDARD FITTED

Sunshield

OPTIONAL ACCESSORIES

WBAP1-IR, wall mount bracket

SPBAP1-IR, shock-proof bracket