

## SF1 Series

### Stainless Steel Camera Housing



#### MAIN FEATURES

Electro-polished AISI 304 or 316L stainless steel camera housing

Accommodates most camera and lens combinations

IP 68 (2m/2hr) protection

Built in sunshield and thermostatically controlled heater

Built-in wiper with telemetry receiver  
(for model SF1-W)



SF1-W

SF1 Series fixed camera housing is designed for extreme environment operation with IP68 ingress protection rating, constructed from Stainless Steel AISI 304 or 316L materials (to be specified by client). It comes with built-in sunshield to reduce the temperature caused by direct sunlight and built-in thermostatically control heater to compensate for low temperature environment operation. The optional built-in wiper mechanism (with SF1-W model) may reduce the effect of dusts, rain drops and condensates on the camera sight glass, for improved video quality.

SF1 Series camera housing shall be able to accommodate most type of camera and lens combinations, for easier application in different environment.

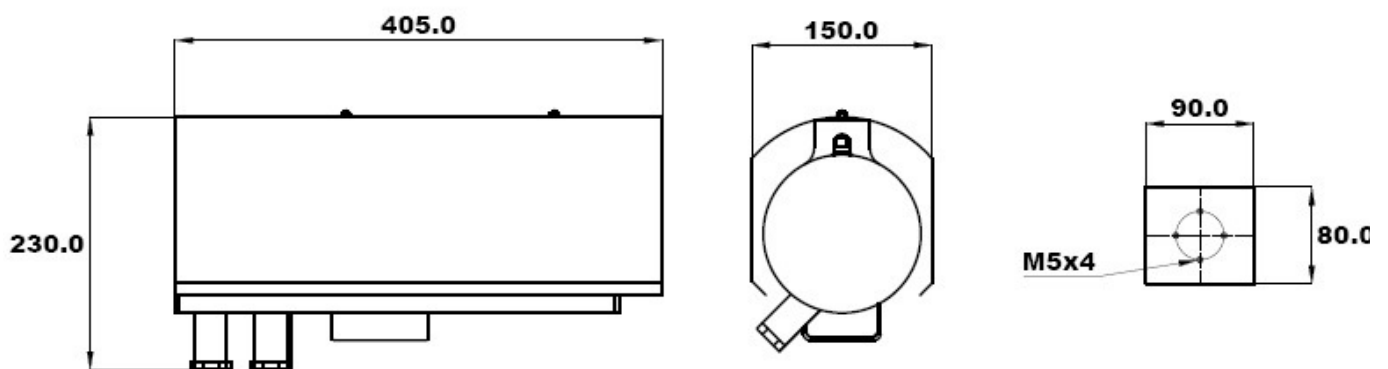

Outline Dimensions (model SF1-W)

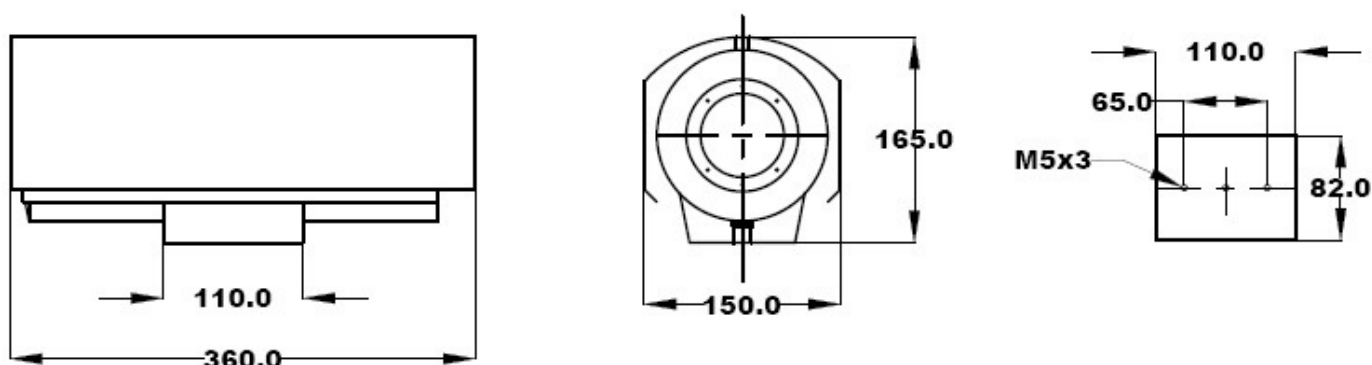

Outline Dimensions (model SF1)

## SF1 Series

### Stainless Steel Camera Housing



#### TECHNICAL DATA

SF1		SF1-W
GENERAL		
Ingress Protection	IP68（2m/2hr）	
Operating Temperature	-40℃ to 60℃	
MECHANICAL		
Material	304 / 316L Stainless steel material (please specify)	
Built-in Wiper Mechanism	No	Yes
Overall Dimension (WxHxD)	150x165x360mm	150x230x405mm
Sight Glass Dimension	φ73mm	
Internal Housing Usable Size	φ105×330mm	
Cable Entries	2×G1/2” cable entries, inner hole φ13mm	
Weight (without camera and lens)	8kg	9kg
ELECTRICAL		
Operating Voltage	AC110V ~ AC240V 50/60Hz, or AC24V 50/60Hz (please specify)	
Current	≦500mA Current	
TELEMETRY RECEIVER		
Connection	-	RS485 or RS422
Protocol	-	Pelco D or Pelco P (please specify)
STANDARD FITTED		
Sunshield	Yes	Yes
Thermostatically Controlled Heater	Yes	Yes
OPTIONAL ACCESSORIES		
Wall Mount Bracket	WBSF1	WBSF1-W